

York County Shore

Lancaster County Shore

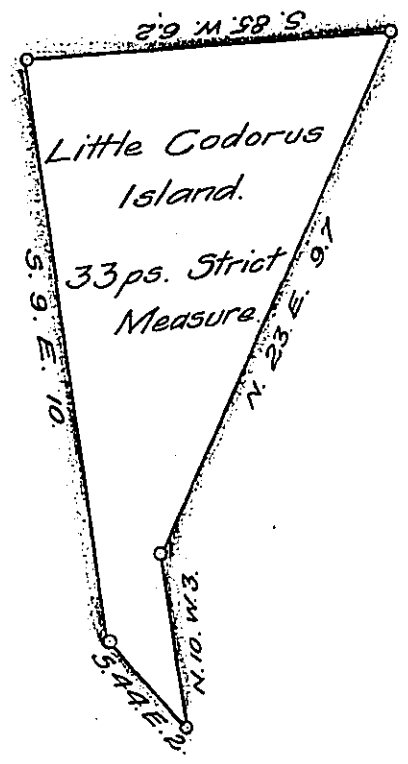

A Draught of an Island situate in the river Susquehanna in Donegal township in the County of Lancaster called Little Codorus Island opposite lands of John B. Haldeman on the Lancaster Shore and on the York side opposite John Redens Island and near the head of Henry B. Grubbs Island Containing thirty three perches Strict Measure surveyed in pursuance of a warrant bearing date the twelfth day of February Anno Domini 1816 Granted to Henry Haldeman.

p<sup>c</sup> Jacob Hibshman D.S.

To Jacob Spangler Esq<sup>r</sup> }  
 Surveyor General. }

IN TESTIMONY that the above is a copy of the original remaining on file in the Department of Internal Affairs of Pennsylvania, made conformably to an Act of Assembly approved the 16th day of February 1833, I have hereunto set my hand and caused the Seal of said Department to be affixed at Harrisburg, this thirteenth day of January 1908.

*Henry Houck*  
 Secretary of Internal Affairs.